



SpitzLift Package Description Document

(Product Cut Sheet/ Install Guide)

PACKAGE DESCRIPTION: FORD F-150 IN-BED FLOOR PEDESTAL, 4 FT DC SPITZLIFT **MAX LOAD CAPACITY:** 900 LBS / 408 KG

PACKAGE ID #: PICKUP OPTION 2 **Right side (Curb Side) Install** **PACKAGE ID #:** PICKUP OPTION 2 **Left side (Driver Side) Install**

☐ **VEHICLE SPECIFIC PACKAGE** **VEHICLE MAKE** FORD **VEHICLE MODEL** F-150 **START YEAR** 2017



PACKAGE IMAGE

PACKAGE SPECIFICATIONS:

FORD F-150 IN-BED FLOOR PEDESTAL
PICKUP OPTION 2
INSTALLS ON RIGHT SIDE
INSTALL WEIGHT: APPROX. 71 LBS
LOAD CAPACITY: 900 LBS
INCLUDES:
12V DC CRANE LTD-424 WITH PENDANT, DC CONNECT & WIRING HARNESS, POST MAST KPHBS-026, PEDESTAL KBP-F150-17 WITH INSTALLATION REINFORCEMENT KIT FOR ALUMINUM BEDS

SHIPPING WEIGHTS:

BOX 1 50 **LBS** **BOX 2** 18 **LBS** **BOX 3** **LBS** **BOX 4** **LBS**

SPECIAL NOTES:

PLEASE ALLOW LONGER LEAD TIMES FOR THIS PACKAGE - ESTIMATED 4-6 WEEKS

SPITZLIFT PROPRIETARY DOCUMENT

THE INFORMATION CONTAINED IN THIS DOCUMENT IS THE SOLE PROPERTY OF SPITZLIFT. ANY REPRODUCTION IN PART OR AS A WHOLE WITHOUT THE WRITTEN PERMISSION OF SPITZLIFT IS PROHIBITED.

Printed Document is uncontrolled

SLO03-PDOCF-REV_A_1.23.2019_ENG

SPITZLIFT PICKUP TRUCK PACKAGE - F150 (2017 FORWARD)

RIGHT SIDE (CURB SIDE) KBP-F150-17

DC (PICKUP OPTION 3) | MANUAL (PICKUP OPTION 3M)

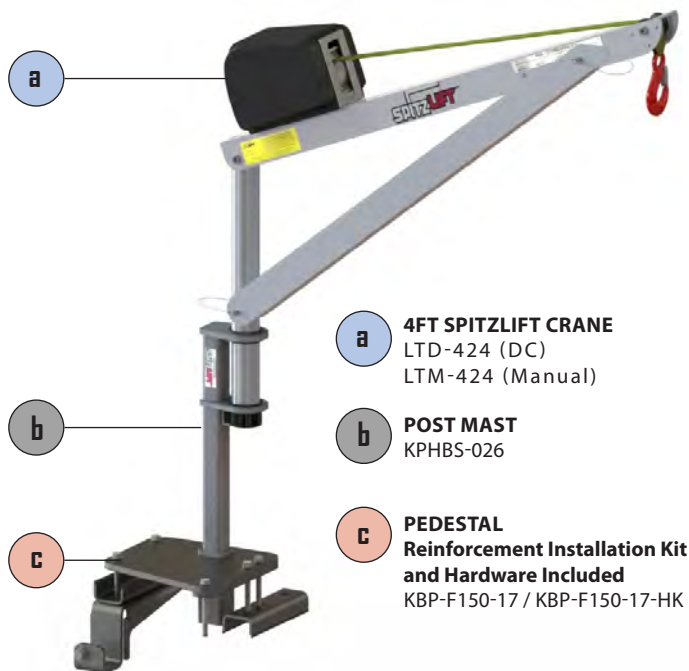

- a** **4FT SPITZLIFT CRANE**
LTD-424 (DC)
LTM-424 (Manual)
- b** **POST MAST**
KPHBS-026
- c** **PEDESTAL Reinforcement Installation Kit and Hardware Included**
KBP-F150-17 / KBP-F150-17-HK



4FT SPITZLIFT CRANE - DC POWERED OR MANUAL	SPECIFICATIONS
MAX LIFTING CAPACITY	900 LBS (408.2 KG)
MANUFACTURING STANDARDS	COMPLIANT WITH OSHA AND ASME STANDARDS
ROTATION	360°
WEBBING OR WIRE ROPE	20' (609.6 CM) 50' (1524 CM)
LIFTING SPEED	DC - 22'6" (6.858 M)/MIN (0.11/SEC)
DC PENDANT CONTROLLER	10' (304.8 CM)
INSTALLED WEIGHT	DC - APPROX. 71 LBS (32.2 KG) MANUAL - APPROX. 66 LBS (29.9 KG)
POWER REQUIREMENTS	12V DC @ 70 AMPS
STANDARD FINISH	CLEAR ANODIZED POWDER COATED
MATERIAL	AIRCRAFT GRADE ALUMINUM & STEEL
WARRANTY	3 YEARS LIMITED



DC Pendant Controller

PART#: 25559-REMOTE10HK
Length: 10' (304.8 CM)



DC Quick Connect

PART#: 24085-4
Length: 4' (121.9 CM)



DC Wiring Harness

PART#: 24049
Length: 25' (762 CM)



Reinforcement Kit

PART#: KBP-F150-17-HK

*Manual Handcrank crane available upon request.

OD DIMS & BOLT REFERENCE

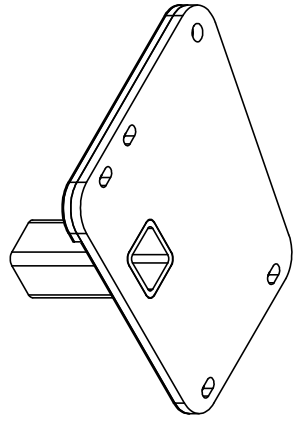
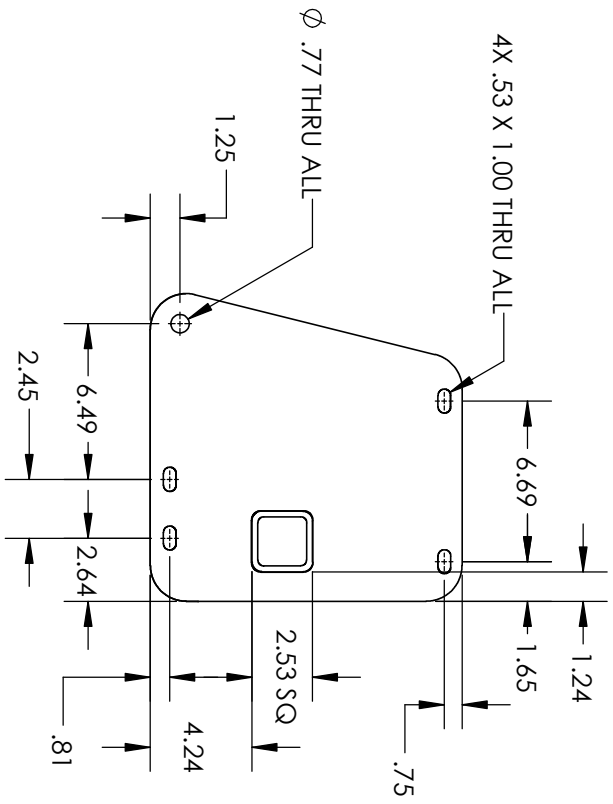

REVISIONS			
ZONE	REV.	DESCRIPTION	DATE
	A	INITIAL RELEASE	10/26/2018

TITLE:

MOUNT, F150 17



MATERIAL DESCRIPTION:

PROPRIETARY AND CONFIDENTIAL THE INFORMATION CONTAINED IN THIS DRAWING IS THE SOLE PROPERTY OF SPITZLIFT INC. ANY REPRODUCTION IN PART OR AS A WHOLE WITHOUT THE WRITTEN PERMISSION OF SPITZLIFT INC IS PROHIBITED.		NAME	DATE	UNLESS OTHERWISE SPECIFIED:		FINISH	MATERIAL:		SIZE	DWG. NO.	REV
DRAWN	SM	10/26/2018	DIMENSIONS ARE IN INCHES TOLERANCES: FRACTIONS: 1/64 DECIMALS: ±.005 ANGULAR: MACH ± 1 DEG BEND/WELD ± 1/16 ± 1 DEG DECIMAL: ±.01		SEE NOTES	DO NOT SCALE DRAWING	N/A		A	KBP-F150-17	A
CHECKED	MJS	10/26/2018							SCALE: 1:8	WEIGHT: 28.16	SHEET 1 OF 1
ENG APPR.	MJS	10/26/2018									

SPITZLIFT PICKUP TRUCK PACKAGE- F150 (2017 FORWARD)

RIGHT SIDE (CURB SIDE) | KBP-F150-17

MAX CAPACITY 900 / 408 KG



INSTALLATION GUIDE

DC OR MANUAL CRANE PEDESTAL INSTALLATIONS

Install on curb side only.

REF	Part Description	Qty
A	KBP-F150-17	1
B	PLATE, BRACE F150-17 HK	2
C	PLATE, BRACE FRAME F150-17 HK	1
D	GASKET, F150-17 HK	1
E	HEX HEAD SCREW, 1/2"-13 X 5.0, G5 ZINC	4
F	HEX HEAD SCREW, M12 X 120, 8.8 ZINC	1
G	WASHER, 1/2" SEALING NEOPRENE, GALV	4
H	FLANGED HEX NUT, 1/2"-13 NYLOC, ZINC	4
I	TEMPLATE, F150-17 MOUNT	1

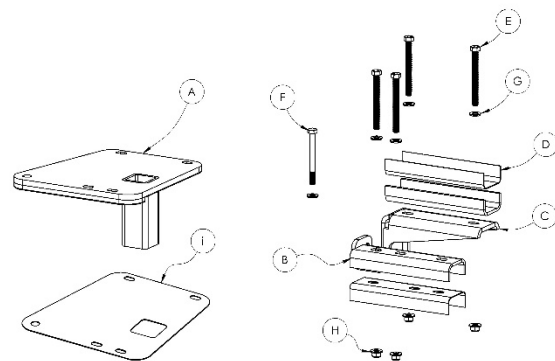

DISCLAIMER: It is recommended that SpitzLift pedestals be professionally installed. SpitzLift is not responsible for the structural integrity of the mounting structure.

CAUTION: Ensure that the location for the pedestal is clear of all wires, harnesses, lines, fuel tank, etc.

Step 1.

- This pedestal is specifically designed to align to pre-existing holes on the vehicle structure. On curbside, from underneath the vehicle, locate the two holes indicated in **(fig I-1)**.
- From the bottom of the vehicle, drill a 1/8" diameter hole straight through the bed floor at each location. These will be used to align a template to mark the holes for drilling.
- Next, on the bed of the vehicle, remove the M12 bolt that holds the bed to the frame, **(fig II-2)**. Place the template **(item I)** on the bed of vehicle. Align to the M12 bolt hole and the 2 qty 1/8" drilled holes. Mark all hole locations on the pedestal and the square cutout for the receiver tube. Drill 17/32"(.53) hole at each of the bolt locations except for the M12 location.

Step 2.

- When cutting the square cutout, only cut three sides of the square as indicated in **(fig III-3)**. Once the three sides are cut, bend the tab back towards the front of the truck as indicated in **(fig IV)**.

Step 3.

- Place the pedestal on the vehicle. Verify that the holes line up, that the receiver pocket penetrates cleanly, and that the pedestal sits flush to the bed.
- Insert the 4 qty 5" hex bolts **(item E)** and the M12 bolt **(item F)**. Tighten the M12 bolt until it is snug.

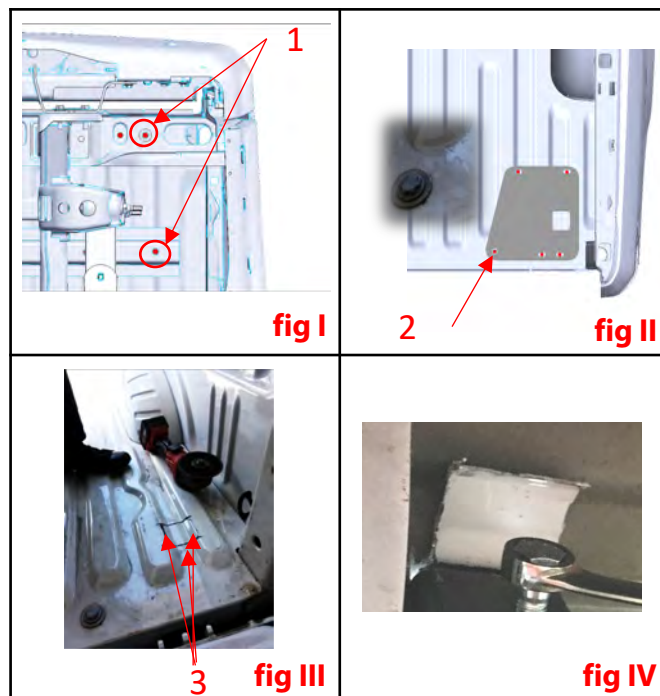

SPITZLIFT PICKUP TRUCK PACKAGE- F150 (2017 FORWARD)

RIGHT SIDE (CURB SIDE) | KBP-F150-17

MAX CAPACITY 900 / 408 KG



Step 4.

- Lower the spare tire to gain access to the bolt that attaches the spare tire heat shield to the frame. Remove the bolt indicated in (fig V-6).
- From the underside of the vehicle, attach the reinforcement installation kit. (item B 2 qty & C).
- When installing the first channel brace (Item B, fig VI-4), ensure the channel flange are facing down toward the ground. Add flanged hex nuts (item H) to hold in place.
- When installing the second channel brace (Item B, fig VI-5) ensure the channel flange are facing up and wrap around the truck's structural member.
- Slide bracket (item C) over the vehicle frame and channel brace (item B). Align all the holes to the bolts. Add the flanged hex nuts (item H) and torque to 75 ft-lbs.
- Locate the locking bolt on the bracket (item C). The bolt locks the bracket to the frame. Tighten the bolt to the frame to lock in place as indicated in (fig VII-7).
- Replace the heat shield and bolt once completed and raise tire back into position.

Step 5.

- When mount has been successfully attached to the vehicle, ensure that everything is structurally sound. Insert the Post Mast into the pedestal. Assemble crane according to operations manual.

Step 6. SpitzLift Automotive Grade Wiring Harness Installation (For DC powered installations, supplied with SpitzLift DC cranes)

DC Wiring Harness components (SpitzLift PN#24049)

- 25 ft. power cable, 8 ft. ground cable
- #8 wire (600v rating UL Type MTW VW-1)
- 70amp (2 qty 35amp) circuit breakers (avg. current draw 50amps)
- Anderson (SB-50) connector



DC Wiring Harness

PART#: 24049
Length: 25' (762 CM)

- Run wiring harness along the chassis of the vehicle. Make certain that both lead wires are properly attached along chassis without sagging and are secured from being pinched.
- Use rubber grommets on any hole penetrations. Ensure that the cable does not contact any heat sources that could cause damage.
- Attach 8 ft. ground lead to chassis. Ensure ground connection is to bare metal, paint, or seal connection after termination
- Run positive 25 ft. lead, which includes automatic circuit breakers, and terminate to positive battery connector or to auxiliary lug.
- Position power supply connector for plugging the SpitzLift extension power cord (4 ft. standard length SpitzLift PN#24085-4) onto the side wall in a location that is unobstructed within 2' of the SpitzLift power unit (fig VIII-8).

Step 7.

Insert SpitzLift into the pedestal and perform recommended load test. 125% of max capacity.

Step 8. (Securing crane for travel)

- Crane must face to the front of vehicle to reduce wind chatter.
- Utilize or install a tie down for locking crane into travel position (fig VIII-9).
- Fasten the hook to the tie down, Reel in the strap to add enough tension to secure the crane. The crane will flex about an inch, indicating that it is secure.
- Then, disconnect the power supply for transport and when crane is not in use. ;.
- Note:** If crane continues to chatter, tighten the strap a little more. Caution do not over tighten (fig VIII).

Step 9.

Unplug power cord for travel and when crane is not in use.



fig V

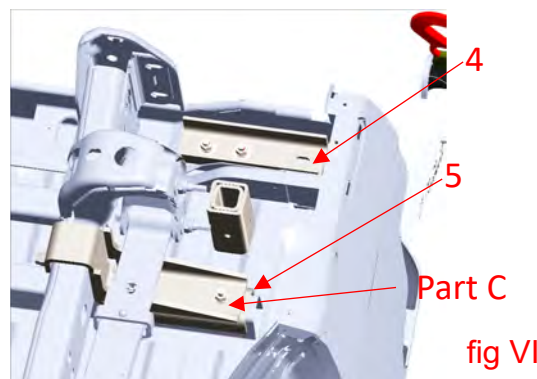

fig VI



fig VII

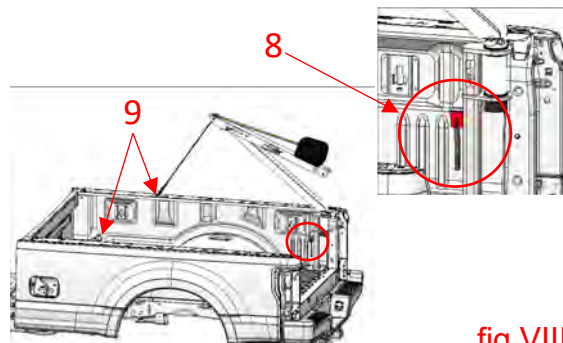

fig VIII