



SpitzLift Package Description Document

(Product Cut Sheet/ Install Guide)

PACKAGE DESCRIPTION: PICKUP TRUCK IN-BED FLOOR PEDESTAL, 4 FT DC SPITZLIFT

MAX LOAD CAPACITY: 900 LBS / 408 KG

PACKAGE ID #: PICKUP OPTION 1

Right side (Curb Side) Install

PACKAGE ID #: PICKUP OPTION 1

Left side (Driver Side) Install



VEHICLE SPECIFIC PACKAGE

VEHICLE MAKE

VEHICLE MODEL

START YEAR



PACKAGE IMAGE

PACKAGE SPECIFICATIONS:

PICKUP TRUCK IN-BED FLOOR PEDESTAL

PICKUP OPTION 1

INSTALLS ON RIGHT OR LEFT SIDE

INSTALL WEIGHT: APPROX. 94 LBS

LOAD CAPACITY: 900 LBS

INCLUDES:

12V DC CRANE LTD-424 WITH PENDANT, DC CONNECT & WIRING HARNESS, POST MAST KPHBS-026, PEDESTAL KBP-1515 WITH INSTALLATION REINFORCEMENT KIT KBP-1515H

SHIPPING WEIGHTS:

BOX 1 50 LBS

BOX 2 18 LBS

BOX 3 60 LBS

BOX 4 10 LBS

SPECIAL NOTES:

SPITZLIFT PROPRIETARY DOCUMENT

THE INFORMATION CONTAINED IN THIS DOCUMENT IS THE SOLE PROPERTY OF SPITZLIFT. ANY REPRODUCTION IN PART OR AS A WHOLE WITHOUT THE WRITTEN PERMISSION OF SPITZLIFT IS PROHIBITED.

Printed Document is uncontrolled

SLO03-PDOCF-REV_A_1.23.2019_ENG

SPITZLIFT PICKUP TRUCK PACKAGE - UNIVERSAL

RIGHT SIDE (CURB SIDE) OR LEFT SIDE (DRIVER SIDE) KBP-1515

DC (PICKUP OPTION I) | MANUAL (PICKUP OPTION IM)

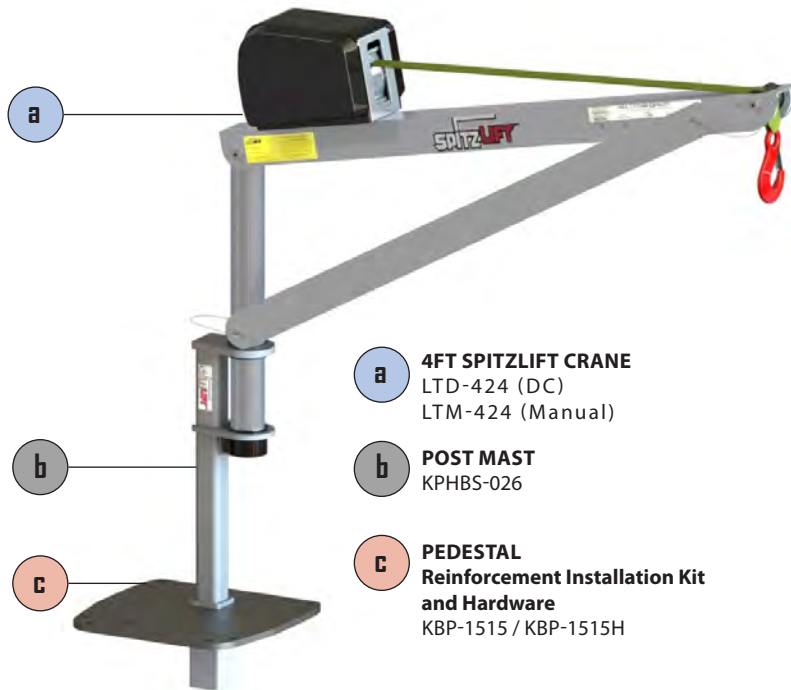

a **4FT SPITZLIFT CRANE**
LTD-424 (DC)
LTM-424 (Manual)

b **POST MAST**
KPHBS-026

c **PEDESTAL**
Reinforcement Installation Kit
and Hardware
KBP-1515 / KBP-1515H



3FT SPITZLIFT CRANE - DC POWERED OR MANUAL	SPECIFICATIONS
MAX LIFTING CAPACITY	900 LBS (408.2 KG)
MANUFACTURING STANDARDS	COMPLIANT WITH OSHA AND ASME STANDARDS
ROTATION	360°
WEBBING OR WIRE ROPE	20' (609.6 CM) 50' (1524 CM)
LIFTING SPEED	DC - 22'6"(6.858 M)/MIN (0.11/SEC)
DC PENDANT CONTROLLER	10' (304.8 CM)
INSTALLED WEIGHT	DC - APPROX. 94 LBS (42.6 KG) MANUAL - APPROX. 73 LBS (33.1 KG)
POWER REQUIREMENTS	12V DC @ 70 AMPS
STANDARD FINISH	CLEAR ANODIZED POWDER COATED
MATERIAL	AIRCRAFT GRADE ALUMINUM & STEEL
WARRANTY	3 YEARS LIMITED



DC Pendant Controller

PART#: 25559-REMOTE10HK
Length: 10' (304.8 CM)



DC Quick Connect

PART#: 24085-4
Length: 4' (121.9 CM)



DC Wiring Harness

PART#: 24049
Length: 25' (762 CM)



Reinforcement Kit

PART#: KBP-1515H

*Manual Handcrank cranes available upon request.

OD DIMS & BOLT HOLE REFERENCE

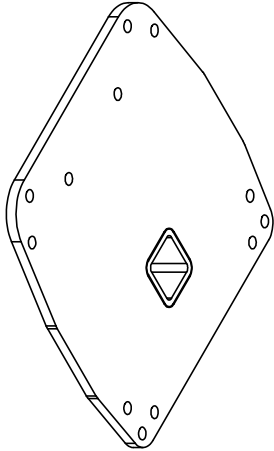
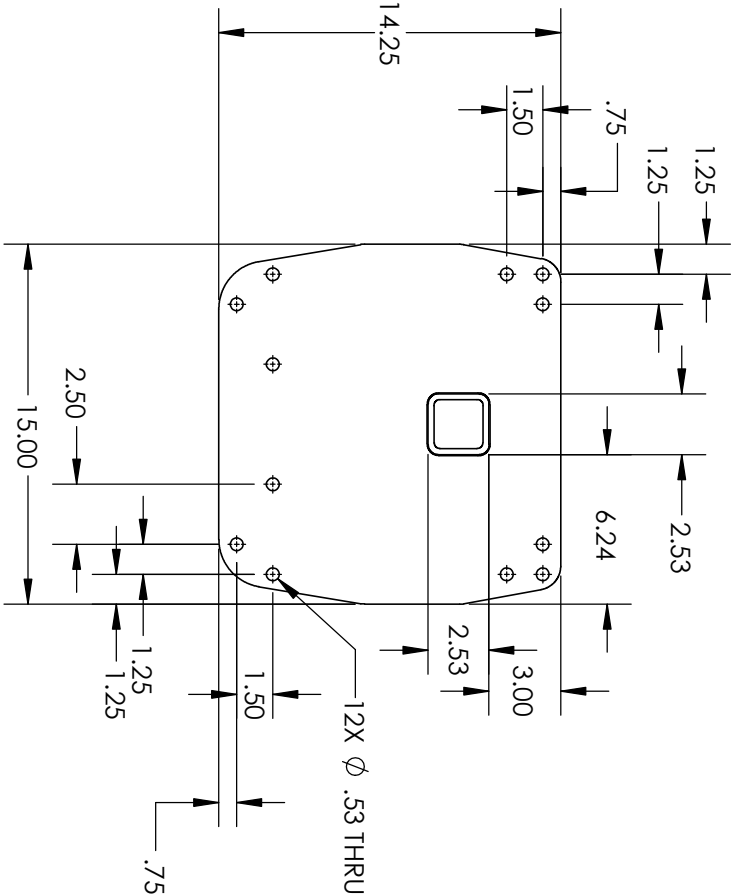

MATERIAL DESCRIPTION:

PROPRIETARY AND CONFIDENTIAL THE INFORMATION CONTAINED IN THIS DRAWING IS THE SOLE PROPERTY OF SPITZLIFT INC. ANY REPRODUCTION IN PART OR AS A WHOLE WITHOUT THE WRITTEN PERMISSION OF SPITZLIFT INC IS PROHIBITED.									
		NAME	DATE	UNLESS OTHERWISE SPECIFIED:					
				DIMENSIONS ARE IN INCHES					
DRAWN		SM	10/25/2018	TOLERANCES: ±.1/64					
				FRACTIONS: 1/64					
CHECKED		MJS	10/25/2018	ANGULAR: MACH ± 1 DEG					
				BEND/WELD: ±1/16 ± 1 DEG					
				DECIMAL: ± .005					
ENG APPR.		MJS	10/25/2018	DECIMAL: ±.01					
				FINISH		MATERIAL: Material <not specified>			
				SEE NOTES					
				DO NOT SCALE DRAWING		PROJECT: KBP-1515			
SIZE		DWG. NO.				REV			
A		KBP-1515		A					
SCALE: 1:8		WEIGHT: 35.40		SHEET 1 OF 1					



TITLE:

MOUNT, 15 X 15

REVISIONS			
ZONE	REV.	DESCRIPTION	DATE
	A	INITIAL RELEASE	10/25/2018

SPITZLIFT PICKUP TRUCK PACKAGE - UNIVERSAL

RIGHT SIDE (CURB SIDE) | LEFT SIDE (DRIVER SIDE) KBP-1515

MAX CAPACITY 900 / 408 KG



REF	Part Description	Qty
A	KBP-1515	1
B	ANGLE, HK KBP-015, 11"	1
C	ANGLE, HK KBP-015, 3"	1
D	FLAT BAR, HK KBP-015, 1.5"	1
E	FLATBAR, HK KBP-015, 6"	1
F	FLAT BAR, HK KBP-015, 15"	1
G	PIPE SCH 80, .50 X .50	1
H	PIPE SCH 80, .50 X 1.0	1
I	PIPE SCH 80, .50 X 1.5	1
J	PIPE SCH 80, .50 X 2.0	1
K	PIPE SCH 80, .50 X 3.0	1
L	HEX HEAD BOLT, 1/2-13 X 4.0, G5 ZINC	1
M	HEX HEAD BOLT, 1/2-13 X 4.0, G5 ZINC	2
N	HEX HEAD BOLT, 1/2-13 X 4.0, G5 ZINC	2
O	WASHER, 1/2" SEALING NEOPRENE, GALV	4
P	FLANGED HEX NUT, 1/2-13 NYLOC, ZINC	4

INSTALLATION GUIDE

FOR DC OR MANUAL CRANE PEDESTAL INSTALLATIONS

The instructions contained in this document is an overview for installing the pedestal for different makes and models. Installer must use their own discretion to provide the necessary structural integrity for adequate structural installation. SpitzLift is not liable for how the pedestal is installed nor the structural integrity of the area SpitzLift products are attached to. SpitzLift recommends that the installation is performed by a professional vehicle equipment installer. If there is any concern regarding the installation of this product SpitzLift offers a 30 day return policy from date of shipment from SpitzLift or recognized affiliates.

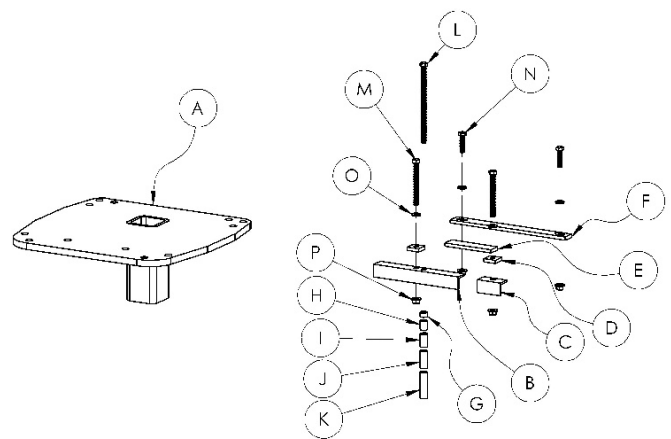

DISCLAIMER: It is recommended that Spitzlift pedestals be professionally installed. Spitzlift is not responsible for the structural integrity of the mounting structure.

CAUTION: Ensure that the location for the pedestal is clear of all wires, harnesses, lines, fuel tank, etc.

Step 1.

- Determine the most appropriate mounting location.
- The pedestal fits in either back corner of the vehicle, near the rear end, and the side of the vehicle. The pedestal is designed to fit so that the receiver tube is closest to the side of the vehicle, and the staggered holes will line up with the vehicle's support frame (**fig I**).
- Ensure that the pedestal will fit properly when the tailgate is closed.

Step 2.

- Once the most appropriate mounting location has been established, mark the location for the receiver tube (**fig II**).
- Cut a 2 3/4" square hole for the receiver tube to fit into.
- Slide the pedestal into place, and mark 4 bolt holes. The KBP-015 is provided with 8 holes for attachment; any 4 of the attachment holes may be used as long as one is in each quadrant. Use the holes that line up with the support frame of the vehicle (**fig III**).

Note: All drilled holes must be properly sealed by liberally applying high grade silicone or other sealant around the perimeter of all holes. If silicone is applied properly, silicone will squeeze out. Remove excess silicone after completion of installation.

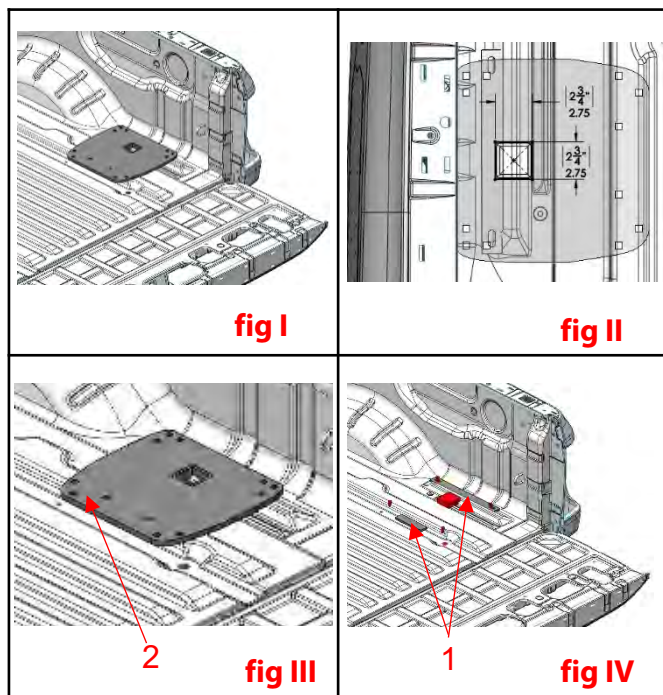

SPITZLIFT PICKUP TRUCK PACKAGE - UNIVERSAL

RIGHT SIDE (CURB SIDE) | LEFT SIDE (DRIVER SIDE) KBP-1515

MAX CAPACITY 900 / 408 KG



Step 3.

- Remove pedestal from location. Use the pieces of flat bar (**item E & F**) to fill in the gaps between the surface plate and the bed of the vehicle, caused by the ridges of the bed, in order to add support and to prevent deformation (**fig IV-1**).
- Use provided pieces of steel angle (**item B**) to strengthen bolts that are not positioned through framing members (**fig V**). Hand tighten a hex nut (**item P**) to each bolt to hold the pieces in place.
- For the front inside hole (**fig III-2**), use pieces of tubing (**item G, H, I, J, & K**) between the bed and the frame of the vehicle to channel the load (**fig VI**).
- If bolt was removed (**step 2**) and old hole can be used, replace the bolt with appropriate bolt diameter and threads. If new hole is being used, use a adequate support member to add support to the bolt underneath the vehicle. Hand tighten to hold the piece into place.
- Place all 4 bolts with nuts in desired location (**fig VII**). Torque 1/2 gr5 bolts to 75 ft-lb.

Step 4.

- When mount has been successfully attached to the vehicle, ensure that everything is structurally sound. Insert the Post Mast into the pedestal. Assemble crane according to operations manual.

Step 5. SpitzLift Automotive Grade Wiring Harness Installation (For DC powered installations, supplied with SpitzLift DC cranes)

DC Wiring Harness components (SpitzLift PN#24049):

- 25 ft. power cable, 8 ft. ground cable.
- #8 wire (600v rating UL Type MTW VW-1)
- 70amp (2 qty 35amp) circuit breakers (avg. current draw 50amps)
- Anderson (SB-50) connector



DC Wiring Harness

PART#: 24049
Length: 25' (762 CM)

- Run wiring harness along the chassis of the vehicle. Make certain that both lead wires are properly attached along chassis without sagging and are secured from being pinched.
- Use rubber grommets on any hole penetrations. Ensure that the cable does not contact any heat sources that could cause damage.
- Attach 8 ft. ground lead to chassis. Ensure ground connection is to bare metal, paint, or seal connection after termination
- Run positive 25 ft. lead, which includes automatic circuit breakers, and terminate to positive battery connector or to auxiliary lug.
- Position power supply connector for plugging the SpitzLift extension power cord (4 ft. standard length **SpitzLift PN#24085-4**) onto the side wall in a location that is unobstructed within 2' of the SpitzLift power unit (**fig IX-3**).

Step 6.

- Insert SpitzLift into the pedestal and perform recommended load test. 125% of max capacity.

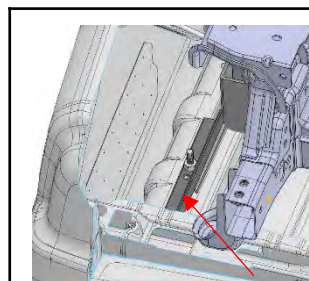

fig V

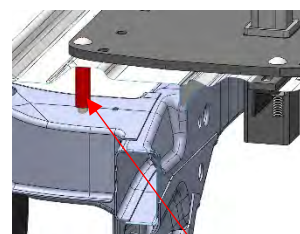

fig VI

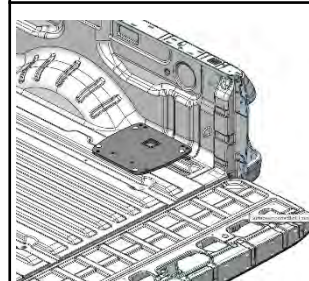

fig VII

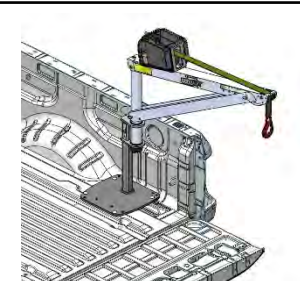

fig VIII

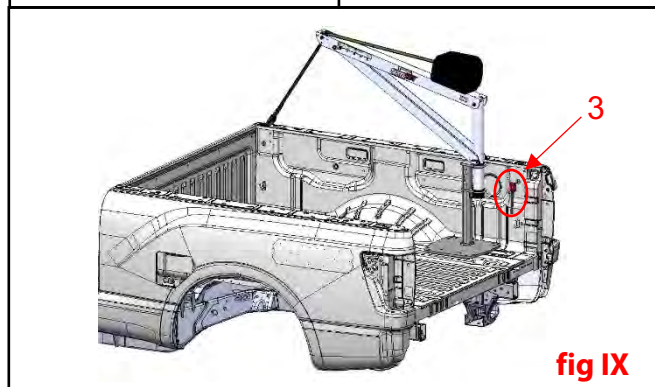

fig IX

Step 7. (Securing crane for travel)

- Crane must face to the front of vehicle to reduce wind chatter.
- Utilize or install a tie down for locking crane into travel position (**fig VIII-9**).
- Fasten the hook to the tie down, Reel in the strap to add enough tension to secure the crane. The crane will flex about an inch, indicating that it is secure.
- Then, disconnect the power supply for transport and when crane is not in use. ;.
- Note:** If crane continues to chatter, tighten the strap a little more. Caution do not over tighten (**fig VIII**).

Step 8.

Unplug power cord for travel and when crane is not in use.