



SpitzLift Package Description Document

(Product Cut Sheet/ Install Guide)

PACKAGE DESCRIPTION: FORD TRANSIT REAR DOOR FOLD-DOWN SPITZLIFT

MAX LOAD CAPACITY: 650 LBS / 295 KG

PACKAGE ID #: OPTION 1 - FT

Right side (Curb Side) Install

PACKAGE ID #: OPTION 1 - FT

Left side (Driver Side) Install

☒ **VEHICLE SPECIFIC PACKAGE**

VEHICLE MAKE

FORD

VEHICLE MODEL

ALL TRANSIT VANS

START YEAR

2016



PACKAGE IMAGE

PACKAGE SPECIFICATIONS:

Ford Transit Rear Door Fold-Down SpitzLift

Option 1 - FT

Installs on either Left or Right Side

Install Weight: Approx. 91 lbs

Load Capacity: 650 lbs

Includes: 12V DC 3ft. Fold-Down Crane LTD-3QRT with Pendant, DC Connect & Wiring Harness, 13" Pivot Mast Z-LTPT13 (taller options available),

Pedestal KBPSG-010-030 with Installation Reinforcement Kit KBP-1012-FTH

SHIPPING WEIGHTS:

BOX 1 50 LBS

BOX 2 46 LBS

BOX 3 10 LBS

BOX 4 LBS

SPECIAL NOTES:

SPITZLIFT PROPRIETARY DOCUMENT

THE INFORMATION CONTAINED IN THIS DOCUMENT IS THE SOLE PROPERTY OF SPITZLIFT. ANY REPRODUCTION IN PART OR AS A WHOLE WITHOUT THE WRITTEN PERMISSION OF SPITZLIFT IS PROHIBITED.

Printed Document is uncontrolled

SL003-PDOCF-REV_A_4.10.2019_ENG

SPITZLIFT VAN PACKAGE: FORD TRANSIT REAR DOOR

RIGHT SIDE (CURB SIDE) | LEFT SIDE (DRIVER SIDE) KBPSG-010-030

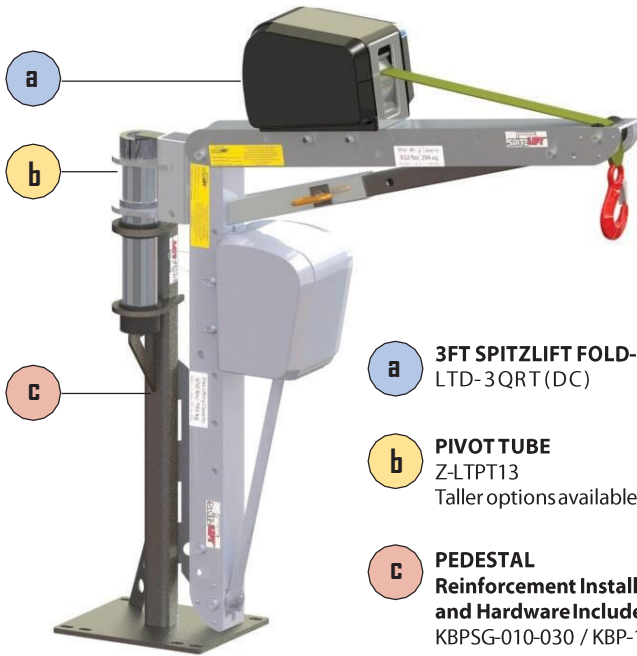

- a** 3FT SPITZLIFT FOLD-DOWN CRANE LTD-3QRT(DC)
- b** PIVOT TUBE Z-LTPT13
Taller options available
- c** PEDESTAL Reinforcement Installation Kit and Hardware Included
KBPSG-010-030 / KBP-1012-FTH



3 FT SPITLIFT FOLD-DOWN CRANE - DC POWERED	SPECIFICATIONS
MAX LIFTING CAPACITY	650 LBS (294.8 KG)
MANUFACTURING STANDARDS	COMPLIANT WITH OSHA AND ASME STANDARDS
ROTATION	360°
WEBBING OR WIRE ROPE	20' (609.6 CM) 50' (1524 CM)
LIFTING SPEED	DC - 22'6" (6.858 M)/MIN (0.11/SEC)
DC PENDANT CONTROLLER	10' (304.8 CM)
INSTALLED WEIGHT	DC - APPROX. 91 LBS (41.3 KG)
POWER REQUIREMENTS	12V DC @ 70 AMPS
STANDARD FINISH	CLEAR ANODIZED POWDER COATED
MATERIAL	AIRCRAFT GRADE ALUMINUM & STEEL
WARRANTY	3 YEARS LIMITED



DC Pendant Controller

PART#: 25559-REMOTE10HK
Length: 10' (304.8 CM)



DC Quick Connect

PART#: 24085-4
Length: 4' (121.9 CM)



DC Wiring Harness

PART#: 01-C-100000
Length: 35' (1066.8 CM)



Reinforcement Kit

PART#: KBP-1012-FTH

*Manual Handcrank Options available upon request.

www.spitzlift.com | (619) 713-5061

SL003-SCS-REV_A_4.16.2019_ENG

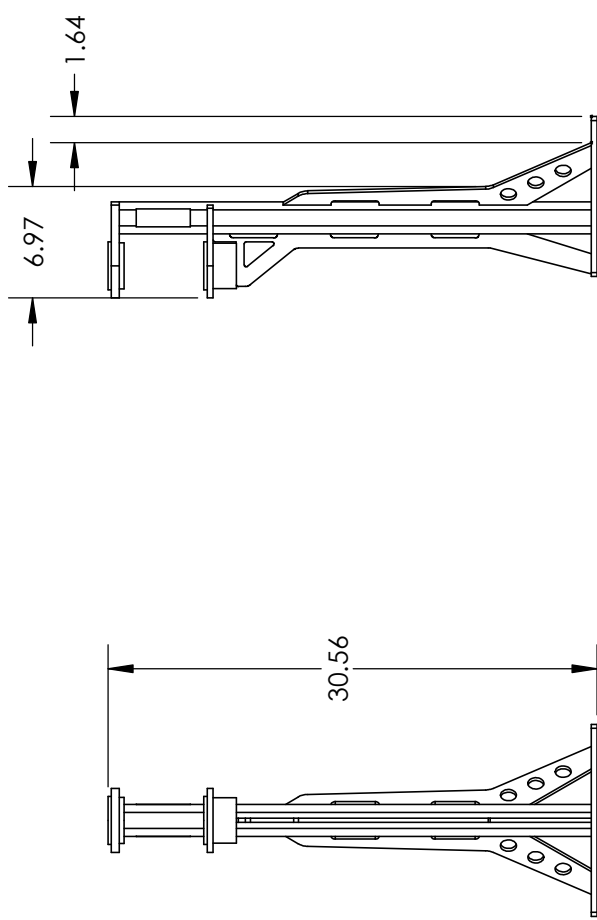
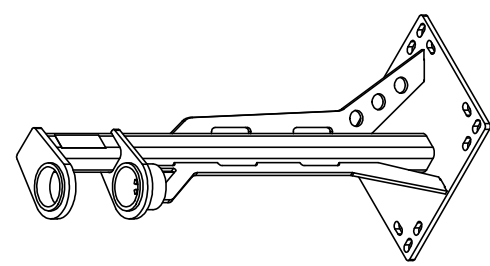
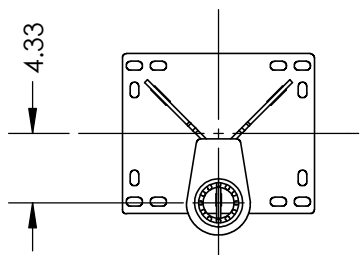
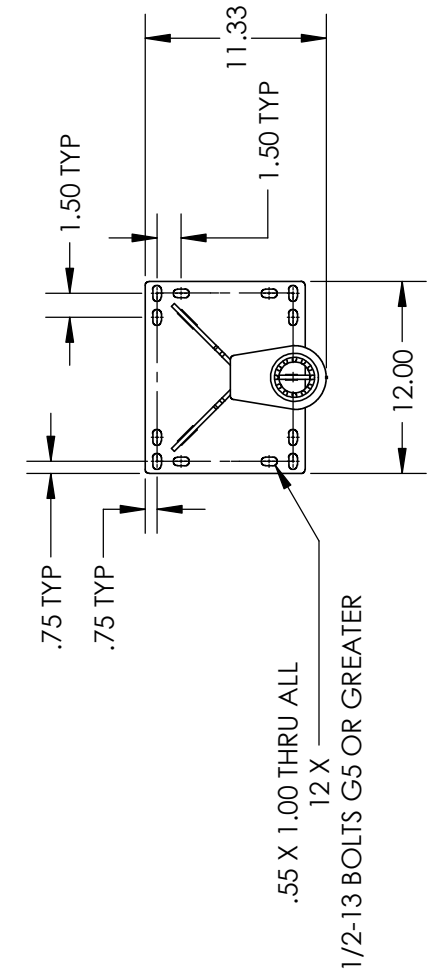

REVISIONS		
ZONE REV.	DESCRIPTION	DATE
A	INITIAL RELEASE	-
B	ADDED RIBS	11/15/2019



TITLE:

MATERIAL DESCRIPTION:

MOUNT, 30" GUSSETED

PROPRIETARY AND CONFIDENTIAL THE INFORMATION CONTAINED IN THIS DRAWING IS THE SOLE PROPERTY OF SPITZLIFT INC. ANY REPRODUCTION IN PART OR AS A WHOLE WITHOUT THE WRITTEN PERMISSION OF SPITZLIFT INC IS PROHIBITED.			NAME	DATE	UNLESS OTHERWISE SPECIFIED:	FINISH SEE NOTES DO NOT SCALE DRAWING	MATERIAL: Material <not specified>	SIZE	DWG. NO.	REV
			DRAWN SM	10/27/2019	DIMENSIONS ARE IN INCHES DECIMALS: $\pm 1/64$ ANGULAR: $MACH \pm 1 \text{ DEG}$ BEND/WELD: $\pm 1/16 \pm 1 \text{ DEG}$ DECIMAL: $\pm .005$ DECIMAL: $\pm .01$		PROJECT: KBPSG-010-030	A	KBPSG-010-030	B
ENG APPR.			MJS	10/27/2019				SCALE: 1:12	WEIGHT: 33.85	SHEET 1 OF 1

SPITZLIFT VAN PACKAGE: FORD TRANSIT REAR DOOR

RIGHT SIDE (CURB SIDE) | LEFT SIDE (DRIVER SIDE) KBPSG-010-030

MAX CAPACITY 650 / 295 KG



INSTALLATION GUIDE

DC OR MANUAL CRANE PEDESTAL INSTALLATIONS
Installation document reflects curb side install.
Can be installed in driver side.

REF	Part Description	Qty
A	KBPSG-010-030	1
B	PLATE, HK SUPPORT BRKT, FTH	1
C	PLATE, HK SPACER 3 X 2, FTH	3
D	HEX HEAD BOLT, 1/2-13 X 7.0, G5 ZINC	1
E	HEX HEAD BOLT, 1/2-13 X 6.0, G5 ZINC	1
F	HEX HEAD BOLT, 1/2-13 X 5.0, G5 ZINC	1
G	HEX HEAD BOLT, 1/2-13 X 3.0, G5 ZINC	1
H	HEX HEAD BOLT, 1/2-13 X 2.0, G5 ZINC	1
I	WASHER, 1/2" SEALING NEOPRENE, GALV	5
J	FLANGED HEX NUT, 1/2-13 NYLOC, ZINC	5

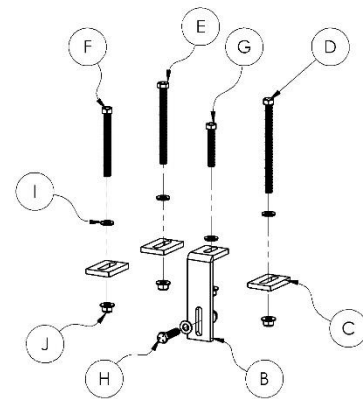
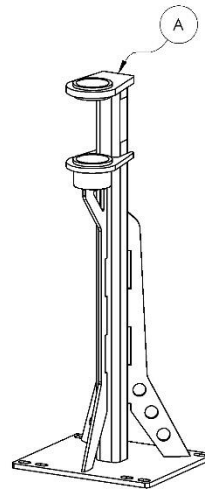

DISCLAIMER: It is recommended that SpitzLift pedestals be professionally installed. SpitzLift is not responsible for the structural integrity of the mounting structure.

CAUTION: Ensure that the location for the pedestal is clear of all wires, harnesses, lines, fuel tank, etc.

Step 1.

- Determine the pedestal location. The pedestal should be aligned with the right- or left-hand inside corner. Holes **1** and **2** (**fig I and II**) are pre-existing holes. Use 17/32 (.53) drill bit and drill from the bottom of the vehicle up through the floor.
Note: All drilled holes must be properly sealed by liberally applying high grade silicone or other sealant around the perimeter of all holes. If silicone is applied properly, silicone will squeeze out. Remove excess silicone after completion of installation.
Note: Both holes tie directly into the chassis. Hole **1** requires a 7" Hex Bolt (**item D**). Hole **2** requires a 6" Hex Bolt (**item E**).
- Set pedestal into position and insert bolts.

Step 2.

- Use the pedestal base plate to locate and mark holes **3** and **4**. It is required that hole **3** is drilled through the chassis as seen in **fig II-3**. Use 5" Hex Bolt (**item F**) at this location. Drill hole **4**, and place L bracket (**item B**) as seen in (**fig II-4 & 5**) to locate position for drilling hole **5**. Drill 17/32 (.53) hole.
- To access the inside of the nut location, remove plastic cover underneath the bottom of the door seal.

Step 3.

- Use bolting plates (**item C**) as seen in **fig II**. Tighten and secure bolts. Torque to 75 ft-lbs.

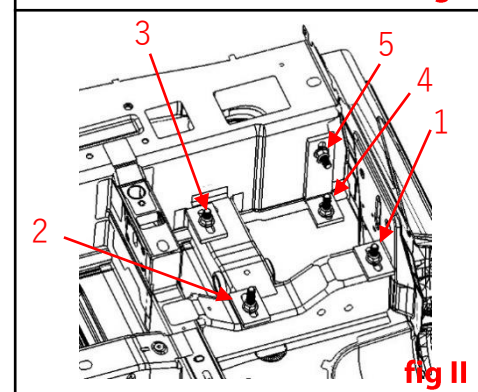
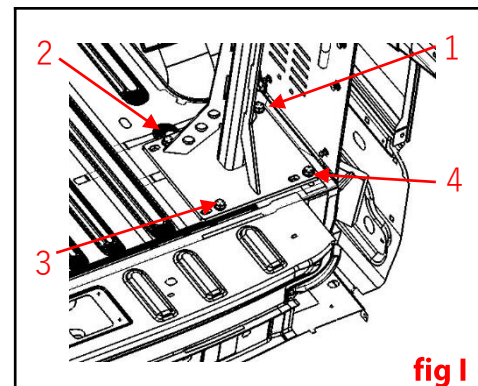

SPITZLIFT VAN PACKAGE: FORD TRANSIT REAR DOOR

RIGHT SIDE (CURB SIDE) | LEFT SIDE (DRIVER SIDE) KBPSG-010-030

MAX CAPACITY 650 / 295 KG



Step 4.

- When pedestal has been successfully fastened to the vehicle, ensure that everything is structurally sound and that all holes are properly sealed with silicone.

Step 5. SpitzLift Automotive Grade Wiring Harness Installation (For DC powered installations, supplied with SpitzLift DC cranes)

DC Wiring Harness components (SpitzLift PN#01-C-100000)

- 35 ft. power cable, 8 ft ground cable.
- #8 wire (600v rating UL Type MTW VW-1)
- 70amp (2 qty 35amp) circuit breakers (avg. current draw 50amps)
- Anderson (SB-50) connector



DC Wiring Harness

Item#: 01-C-100000
Length: 35' (1066.8 CM)

- Run wiring harness along the chassis of the vehicle. Make certain that both lead wires are properly attached along chassis without sagging and are secured from being pinched.
- Use rubber grommets on any hole penetrations. Ensure that the cable does not contact any heat sources that could cause damage.
- Attach 8 ft. ground lead to chassis. Ensure ground connection is to bare metal. Paint or seal connection after termination
- Run positive 25 ft. lead, which includes automatic circuit breakers, and terminate to positive battery connector or to auxiliary lug.
- Position power supply connector for plugging the SpitzLift extension power cord (4 ft. standard length **SpitzLift PN#24085-4**) onto the side wall in a location that is unobstructed within 2' of the SpitzLift power unit (**fig III-6**).

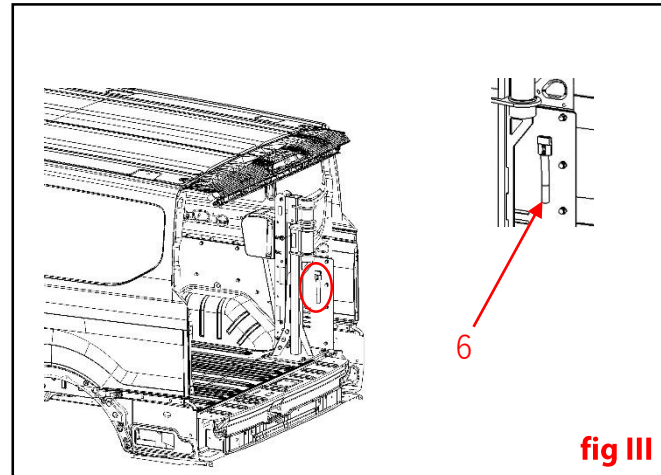

Step 6.

Insert SpitzLift into the pedestal and perform recommended load test. 125% of max capacity.

Step 7. (Securing crane for travel)

- For Fold-Down Cranes**, place crane in folded position and insert hook into eye of pedestal. Reel in webbing or cable to tighten and secure (**fig III**).
- For Non-Folding Cranes**, locate a connecting point within the vehicle to attach the hook. Reel in webbing or cable to tighten and secure. **This may require installation of a tie-down for attaching hook.*

Note: If crane continues to chatter, tighten the strap a little more. Caution– do not over tighten.

Step 8.

Unplug power cord for travel and when crane is not in use.



Reference: **SPITZLIFT OWNER'S MANUAL** for setup and operation of crane.